

Installation

1. Starting from the setting out point (noted on the design layout drawing), lay CTF-IV1 underlay boards, cutting as close to and around roof penetrations. (1.1)
2. Starting from the setting out point, cut the infill surround material to fit between the perimeter and CTF VIP board.
3. Install the infill surround material. Non-solvent PU adhesive can be used to secure small pieces of insulation infill. (1.2)
4. Commence layout of the VIP boards following the pattern as set out on the supplied layout plan.
5. Overlay the CTF VIP boards with CTF-IV1 overlay boards, cutting as close to and around roof penetrations. (1.3)
6. Overlay with the CTF-K Shield membrane (WRFL), turned up at roof edges and seal all sides and end laps with double sided CTF-K Tape.
7. At roof penetrations, cut the CTF-K Shield close and neat to the upstand and form a tight seal.
8. Dress the CTF-K Shield down to rainwater outlets and seal with CTF-K tape.
9. Install specified ballast/ slabs or decking as soon as practical.

General

- Check that all roof dimensions and positions of obstructions correspond to the design layout drawing supplied.
- Ensure that the roof area is clear of all other trades and there is no standing water on the roof areas prior to installation.
- Follow the setting out instructions on the relevant design drawing.
- Install only areas that can be covered with the completed system.
- VIP vacuum panels cannot be cut or altered under any circumstance.

Do not use VIP boards as a working surface. Ensure no following trades can traffic the roof until the ballasted is completed.

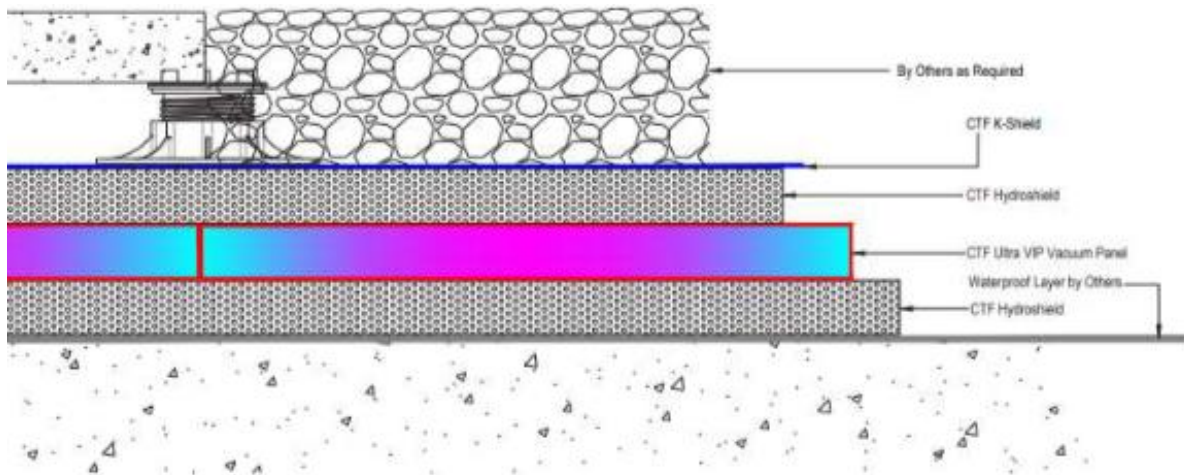

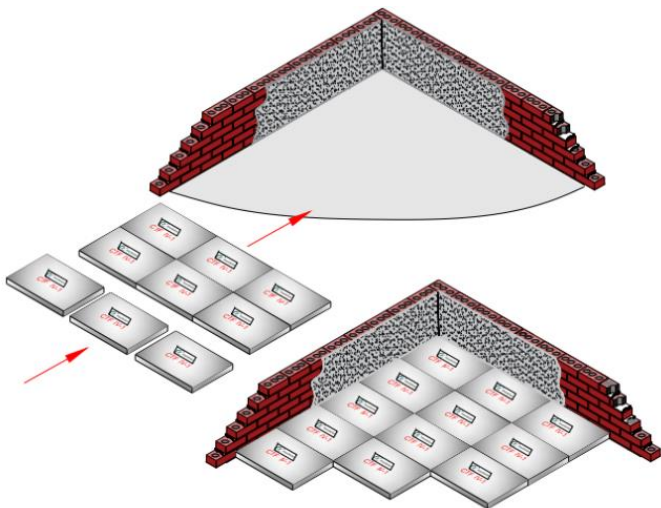
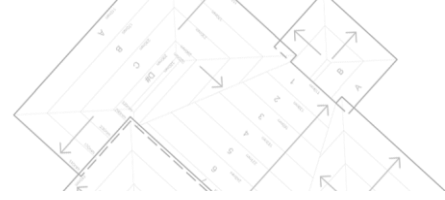

① ~ CTF IV-I UNDERLAY

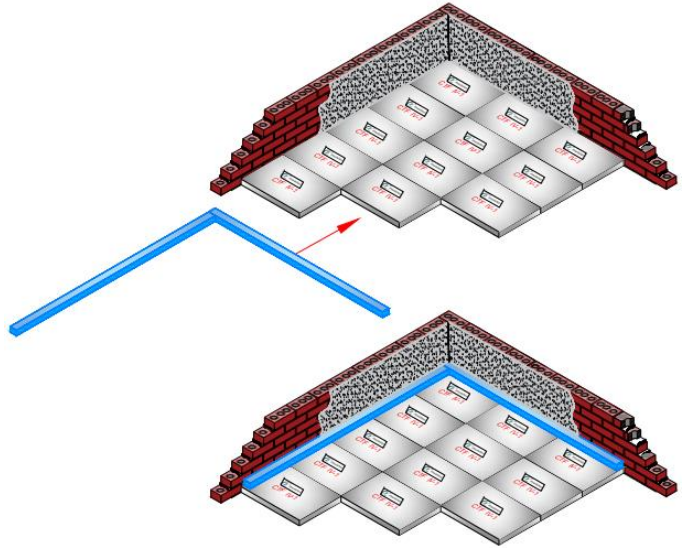

② ~ VIP INFILL

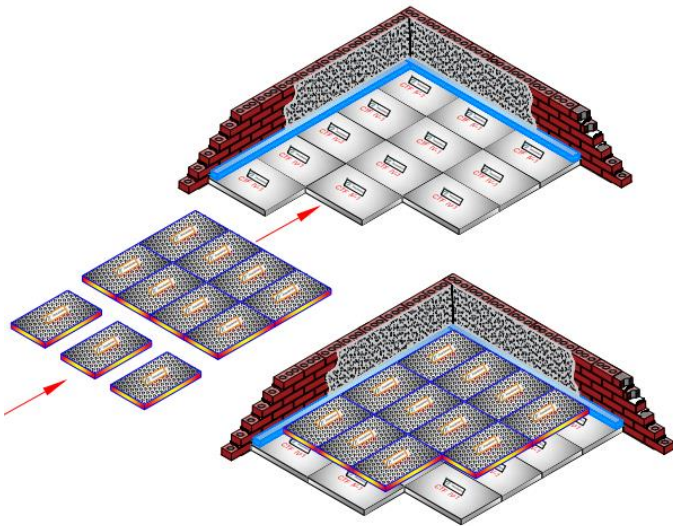

③ ~ CTF VIP

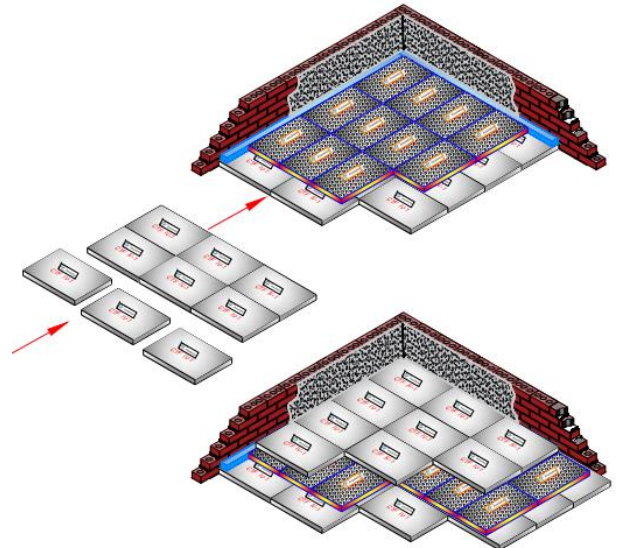

④ ~ CTF IV-I OVERLAY

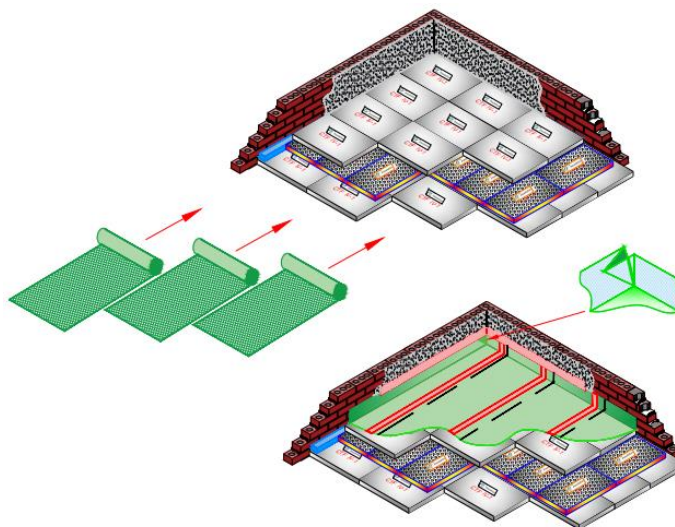

⑤ ~ CTF K-SHIELD (WFRL) SEALED WITH CTF-K TAPE

